

Steelcase

# High Density Storage





## Staying focused in open plan environments

Many organizations have embraced open plan environments, attracted by space optimisation and better collaboration. As a result, too much interaction and not enough privacy damages workers' engagement and wellbeing. Successful collaboration requires giving co-workers easy access to each other. But it also requires giving each individual the time and place to focus.

High Density Storage helps to provide a flexible working environment without any compromise on privacy or comfort.



# Working harder for comfort and space

High Density Storage is designed to work harder for the user. With optimised dimensions, it is designed to extend the workstation and help structure individual collaborative spaces.

## Structuring Spaces

Designed to provide a usable work surface that extends the workstation, allowing for informal conversations, High Density Storage helps to structure open-plan spaces, providing a flexible working environment.

## Height Adjustable Desks

High Density Storage is the personal storage solution, designed specifically to work with height adjustable desks, supporting the users in any posture, be it standing or sitting.

## Optimised dimensions

Monitor sizes are increasing, implying deeper desk sizes in order to maintain a proportional distance between the eyes of the user and the screen. To meet this trend, High Density Storage offers several depths to match the desks depth.







## Balancing privacy and collaboration

High Density Storage maintains privacy and enables users to stay focused in open-plan environments, due to its height, creating a subtle space division solution. Open, you benefit from even more privacy.



# Ergonomics and comfort

High Density Storage helps you organise your documents and tools. Everything stays visible and conveniently close at hand.

Our wide range of 1+1 Organisation tools and internal fittings help you get the best out of the space.

Once closed, it leaves a perfectly tidy workstation.



**Integrated power outlet**  
for power and data access close at hand. Recharge up to three different devices simultaneously, optionally with USB-A charger.



**Highly customisable**  
thanks to add-ons such as shelves, drawers, paper trays, boxes and binder holders or even suspended file frame, it makes routine tasks easier.

## Statement of Line

### Dimensions

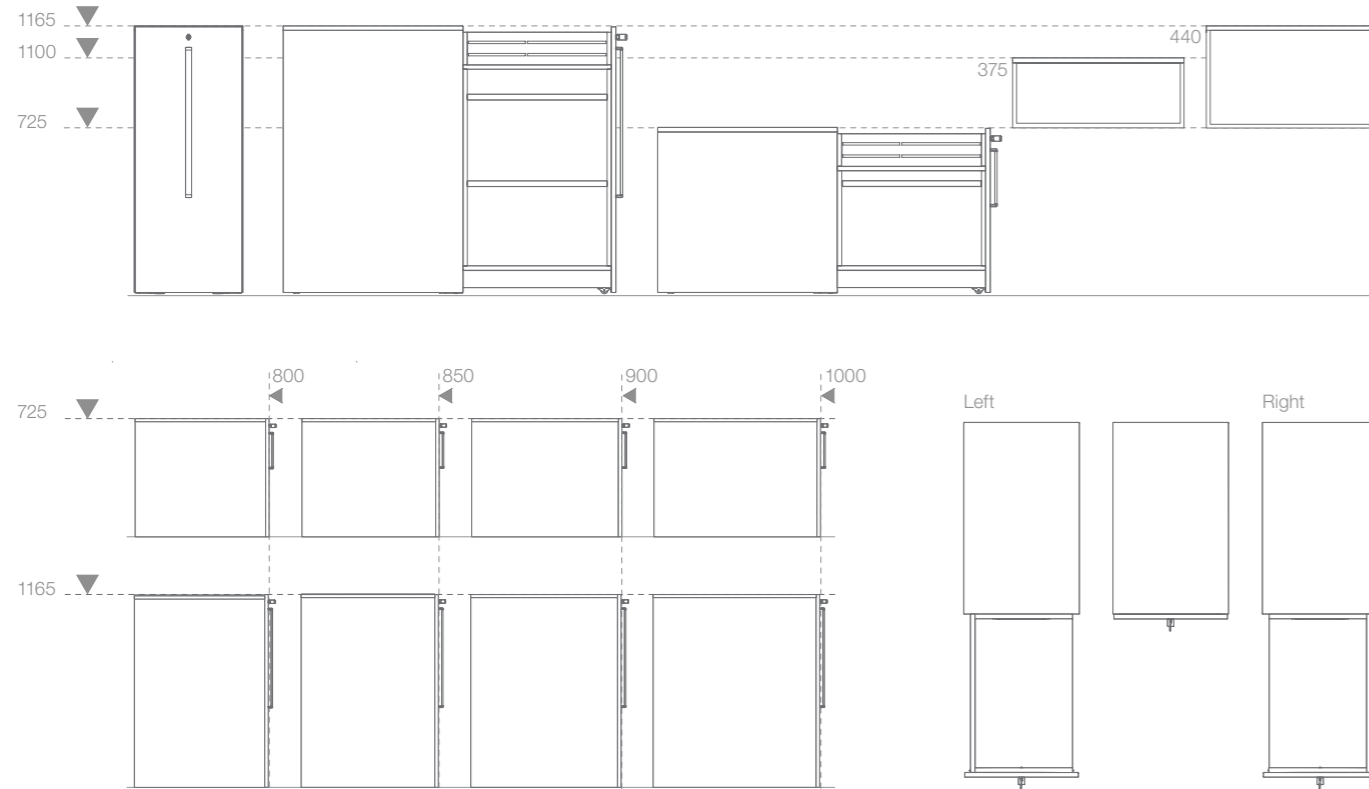

### Handles



GMG

### Power Access

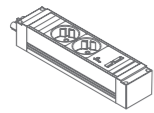

Power socket  
incl USB-A

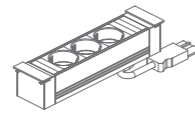

Power socket

### Cable Management



Cabletray/  
powerway

### Surface Materials

#### Body, Top and Front

Melamine

#### Handle

Natural Aluminum EV1

#### Rail

Steelcase Standard Paints

#### Lock

Matt Chrome

#### Internal Shelves

Melamine, Paint

## Designing for the Environment Requires Innovative Thinking and Solutions.



### Life Cycle Assessment

Steelcase considers each phase of the life cycle: from materials extraction, production, transport, use and reuse, through to the end of its life.

### Materials

Contains 20% recycled materials, by weight.

Product is PVC-free.

Packaged with 45% recycled cardboard that uses water-based inks without solvents.

### Production

Manufactured in Stribro, Czech Republic by Steelcase.

Uses powder-coat paints: VOC-free and free of heavy metals.

Water-based adhesives used in manufacturing.

### Transport

Made in Europe, close to customers.

### Use

Designed for a long product life, with replaceable parts.

Materials meet stringent health and indoor air quality criteria.

Maintenance information available on [steelcase.com](http://steelcase.com)

### End of Life

96% recyclable by weight.

Designed for quick and easy disassembly of materials.

Plastic parts clearly labelled for easy sorting and effective recycling, compliant with ISO 11469.

100% theoretically recyclable packaging.

Designed to enable responsible end of use strategies - refurbishing, charitable donation or recycling.

### Certifications

To show continuous improvement, Steelcase communicates the environmental and social performance of its products through voluntary labels and declarations.

### Product

PEP - Product Environmental Profile

NF Environnement

NF Office Excellence Certifié

Blauer Engel

SCS Indoor Advantage™ Gold

### Materials

PEFC™ - Programme for the Endorsement of Forest Certification

### Plants

ISO 9001 - Environmental management system

ISO 14001 - Environmental management system

EMAS - European Eco-Management and Audit Scheme

### Find out More

Sustainability related actions and results are annually communicated in the Steelcase Corporate Sustainability Report. More environmental details available upon request.



**Steelcase**



16-E0000449 05/24 © 2024 Steelcase Inc. All rights reserved. Published by Steelcase Inc. Trademarks contained herein are the property of Steelcase Inc. or of their respective owners. Material in this publication may not be reproduced in any form unless you really want to help people work better — just ask us first, okay?

 [facebook.com/steelcase](https://facebook.com/steelcase)

 [linkedin.com/company/steelcase](https://linkedin.com/company/steelcase)

 [instagram.com/steelcase](https://instagram.com/steelcase)

 [twitter.com/steelcase](https://twitter.com/steelcase)

 [youtube.com/steelcasetv](https://youtube.com/steelcasetv)

 [pinterest.com/steelcase](https://pinterest.com/steelcase)