

004495D Rev B

Installation Instructions

Page 1 of 2

NOTE: Illustrations shown with Underline Light

WSS12L
WSS18L
WSS18P
WSS24L
WSS24P
WSSD-Divider
WSSL-Label Holder

Slatshelf

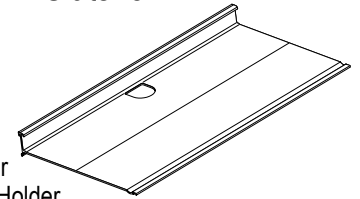

1 Install Slatshelf on Slatwall or SlatRail.

- 1 Insert top hook.
- 2 Rotate shelf to insert bottom hook.
- 3 Press down to engage hooks.

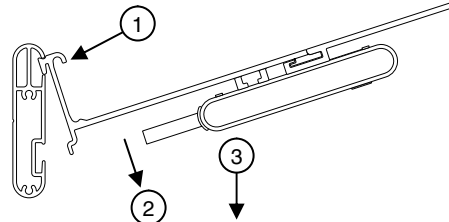
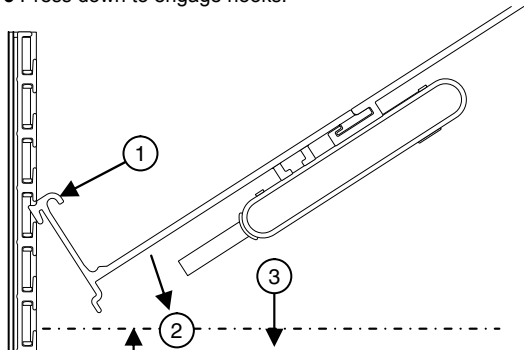

Locate Slatshelf approximately 18" from worksurface for optimal light distribution.

To Remove Slatshelf from Slatwall or SlatRail

- 1 Lift to disengage hooks.
- 2 Rotate out bottom hooks.
- 3 Slide out top hook.

- Install Divider.
- 1 Position divider in desired location.
 - 2 Insert top leg.
 - 3 Rotate down to engage bottom leg.

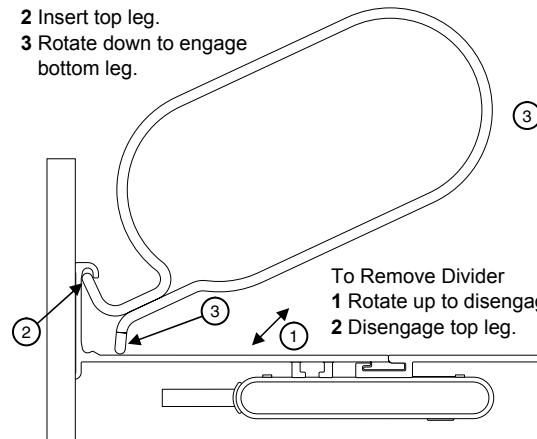

- To Remove Divider
- 1 Rotate up to disengage bottom leg.
 - 2 Disengage top leg.

2 To Mount Underline Light to Slatshelf, Use Hardware Pack R04494DSR

Install (2) Square nuts, (2) Flat Washers, (2) Plastic Spacers and (2) Screws into channel on underside of Slatshelf.

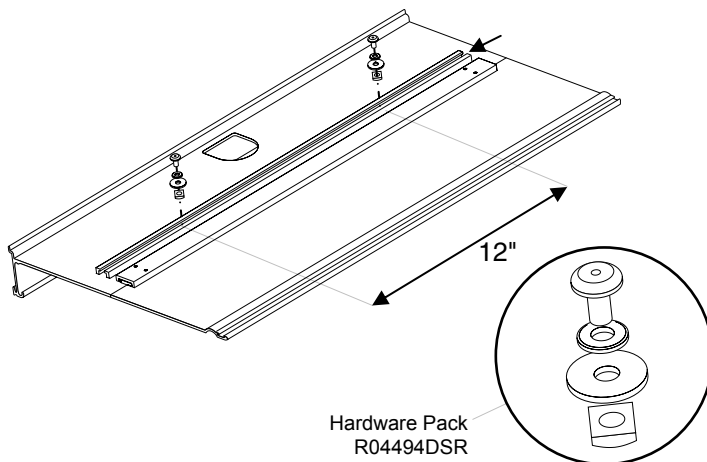

Hardware Pack R04494DSR

3 Remove Underline Light Lens.

- 1 Unsnap front.
- 2 Rotate to disengage rear tabs.

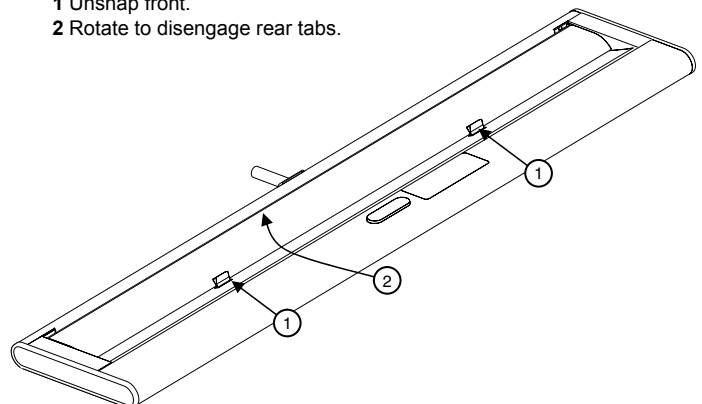

For a better day at work.™

details®

A STEELCASE COMPANY

www.details-worktools.com
Details Customer Alliance 800.833.0411
All rights reserved. Printed in U.S.A. 12/06



Installation Instructions

Page 2 of 2

004495D Rev B

Slatshelf

- WSS12L
- WSS18L
- WSS18P
- WSS24L
- WSS24P
- WSSD-Divider
- WSSL-Label Holder

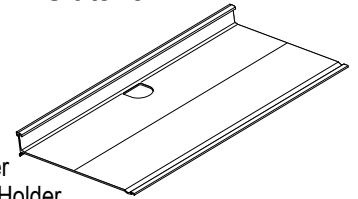

- 4** Assemble Underline Light to Slatshelf.
- 1 Place keyhole slots in Underline Light over mounting hardware.
 - 2 Slide hardware into keyhole slots and tighten screws, fasten Underline Light to Slatshelf.

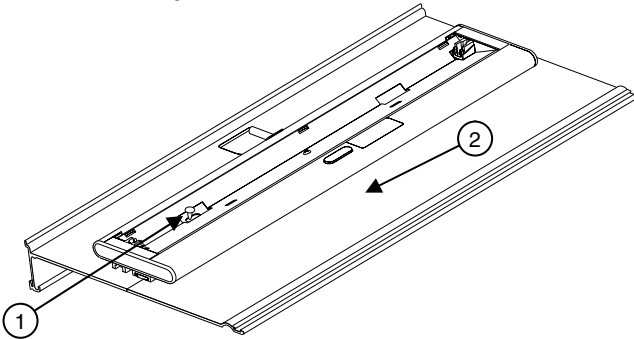

- Replace Underline Light Lens and install wire management.
- 1 Engage rear tabs. Rotate forward to lock.
 - 2 Install cord clips.

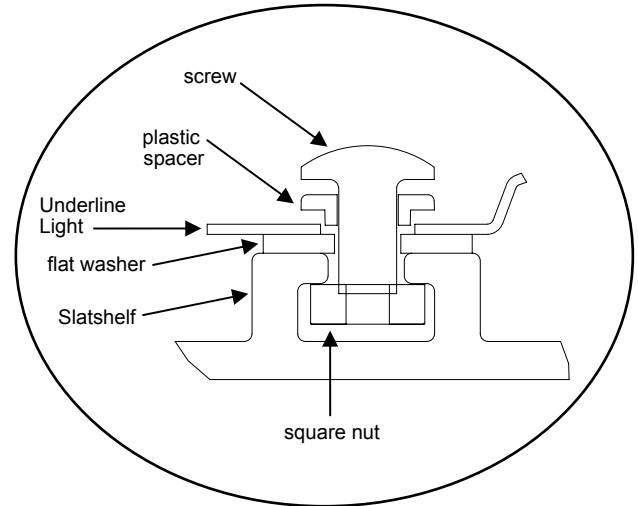

Shown installed using Hardware Pack - R04494DSR

- 5** Install Label Holder and Label.
- 1 Write on label with wet erase marker only.
 - 2 Insert in holder.
 - 3 Engage rear of label holder in slot. Rotate upward to snap label holder onto Slatshelf.

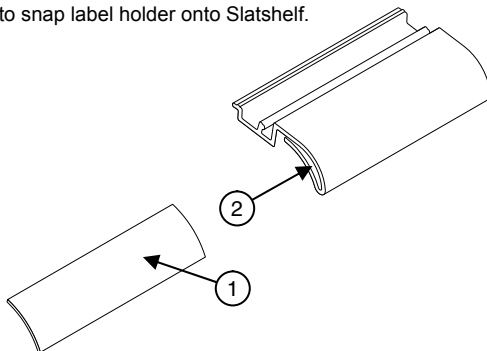

To Remove Label Holder, slide holder out of slot.

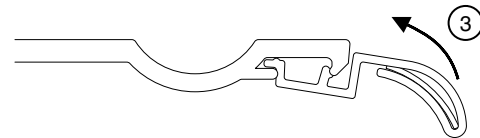

WARNING:

To Prevent Risk of Electrical Shock ...

- 1 All electrical installations must be done by qualified personnel in accordance with codes and regulations applicable at the installation site.
- 2 Before beginning work, ensure that electrical power has been removed from the circuits that lights are being connected to or disconnected from.
- 3 Ensure the circuits that lights are connected to are properly grounded and are the correct voltage.
- 4 To prevent wiring damage or abrasion, do not expose wiring to edges of sheet metal or other sharp objects.

For a better day at work.™

details®

A STEELCASE COMPANY

www.details-worktools.com
Details Customer Alliance 800.833.0411
All rights reserved. Printed in U.S.A. 12/06