

Eight (8) M8 X 25mm countersunk screws on each leg

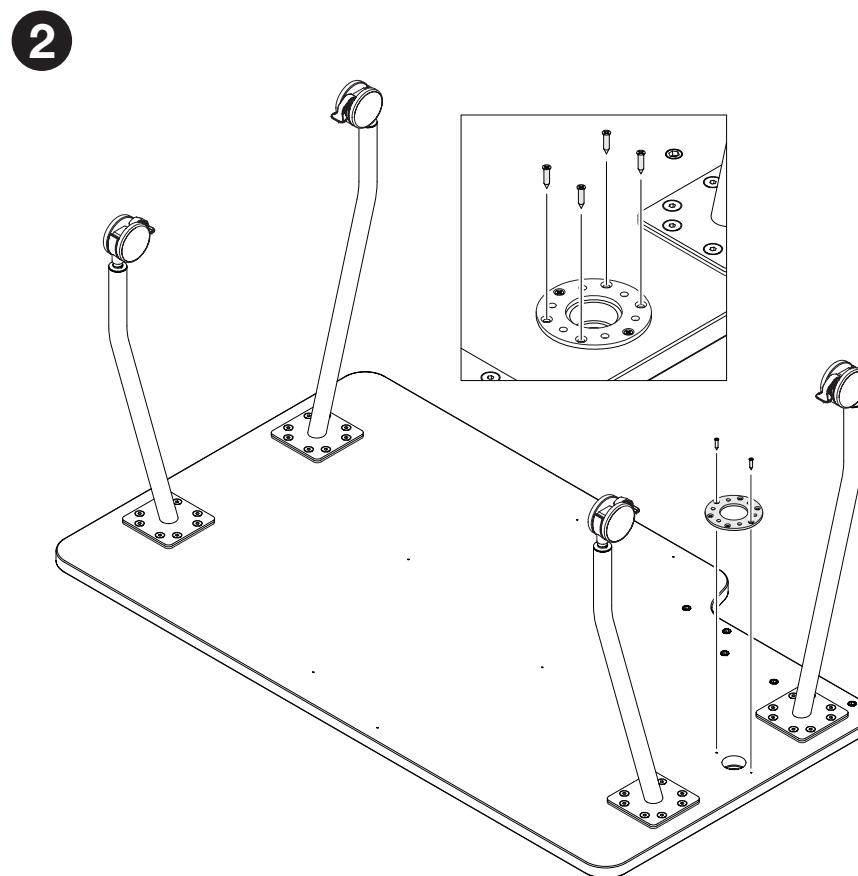

Six (6) self-tap, Ø5 X 23mm, cross, flat, nickel screws

3a

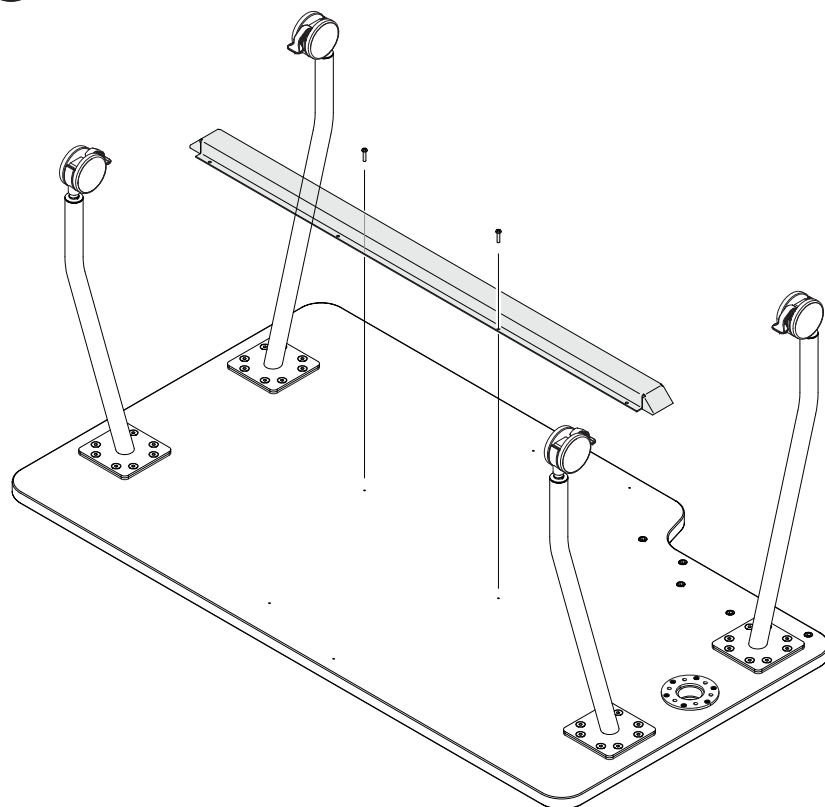

Two (2) Ø5 X 22mm wood screws

3b

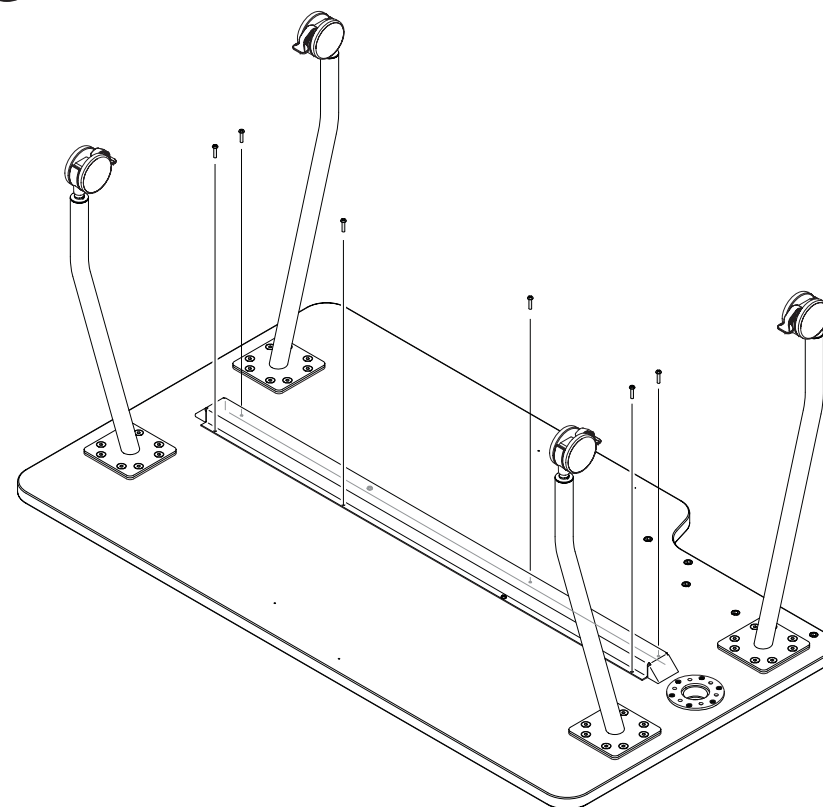

Six (6) Ø5 X 22mm wood screws

4

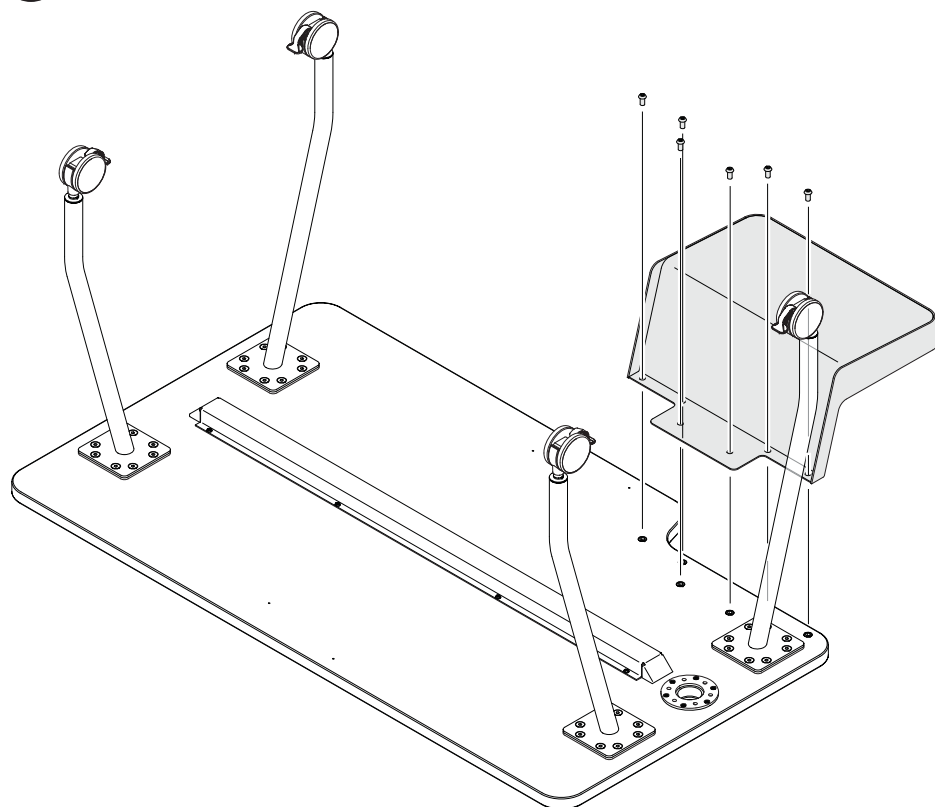

Six (6) M8 X 16, hexagon round head, black screws

5a

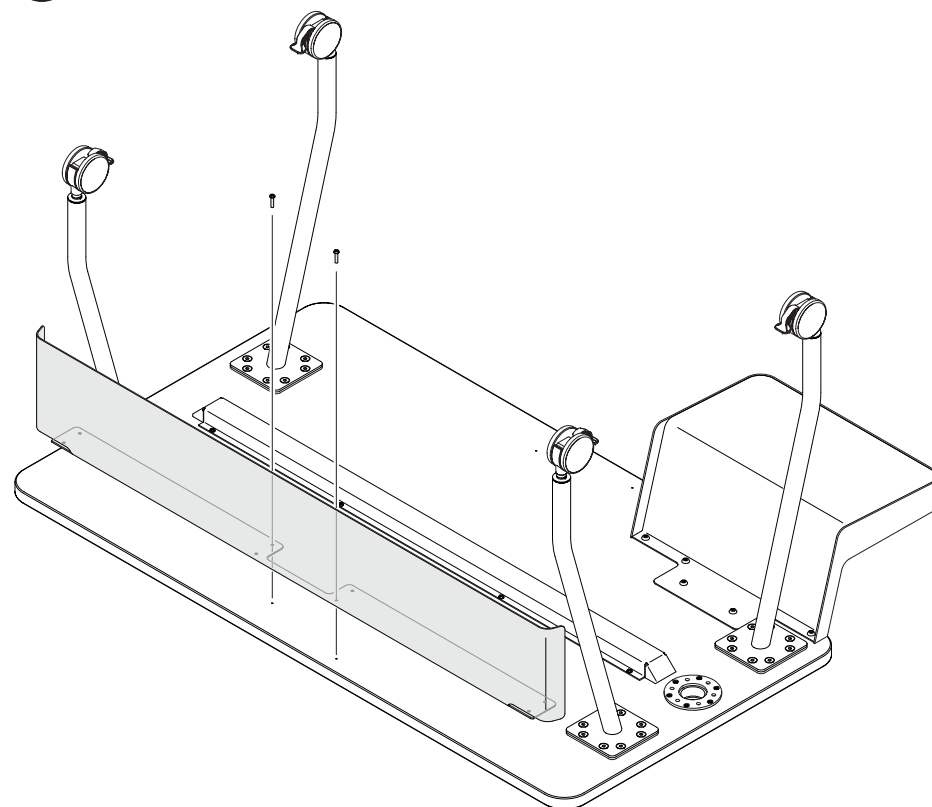

Two (2) Ø5 X 22mm wood screws

5b

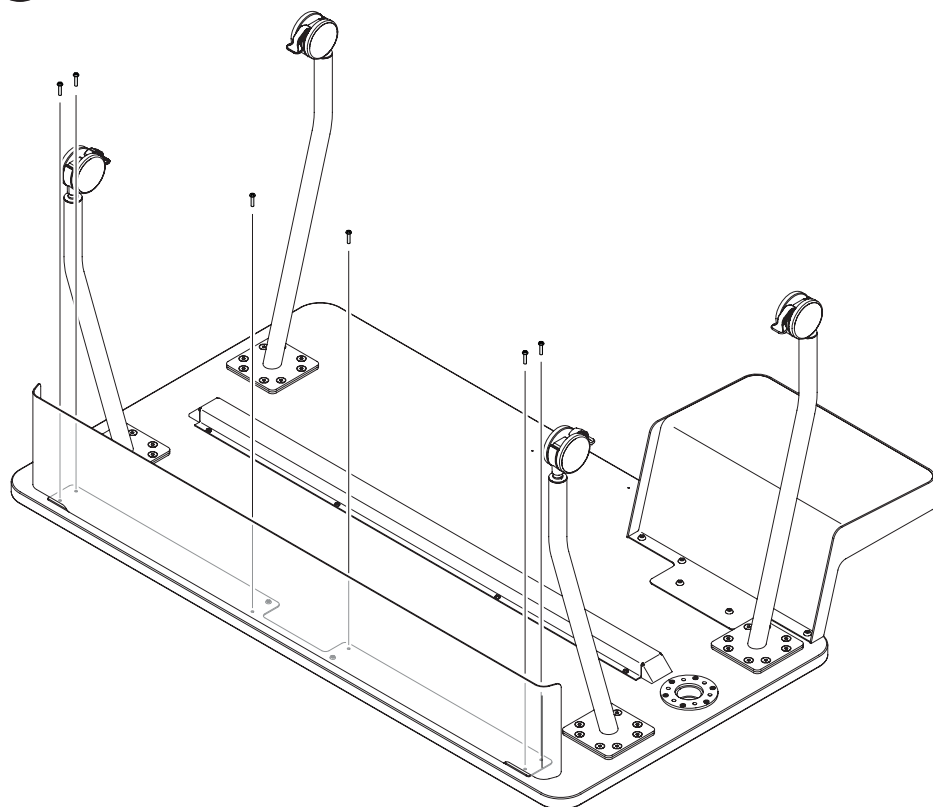

Six (6) Ø5 X 22mm wood screws

6

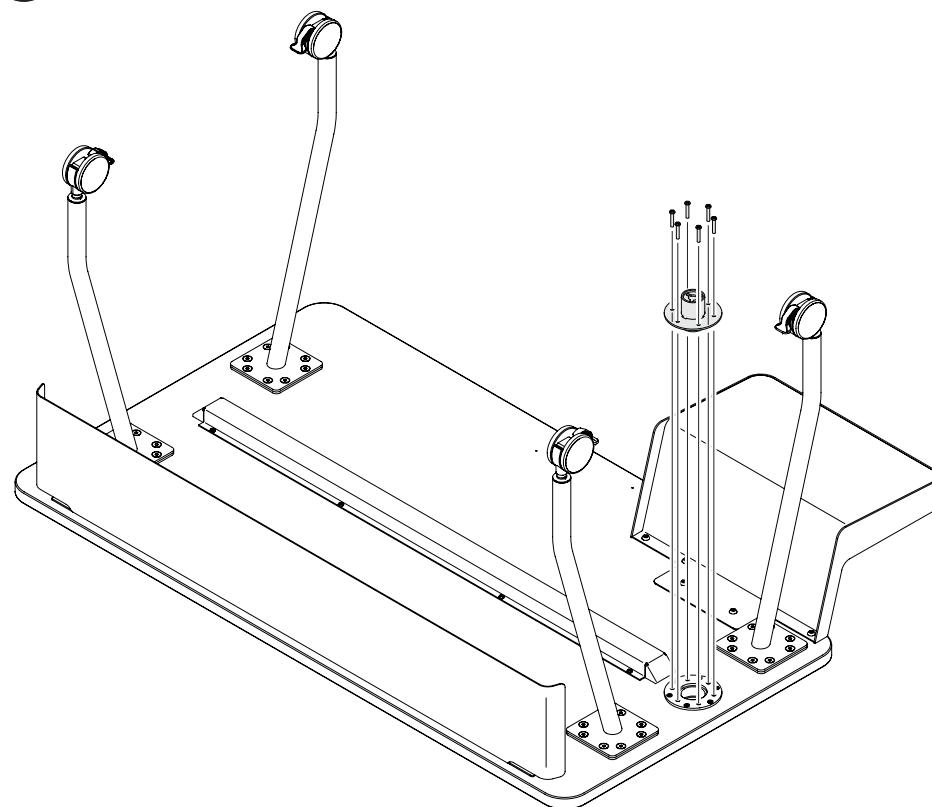

Six (6) self-tap, Ø5 X 30mm, cross, binding, black screws

7

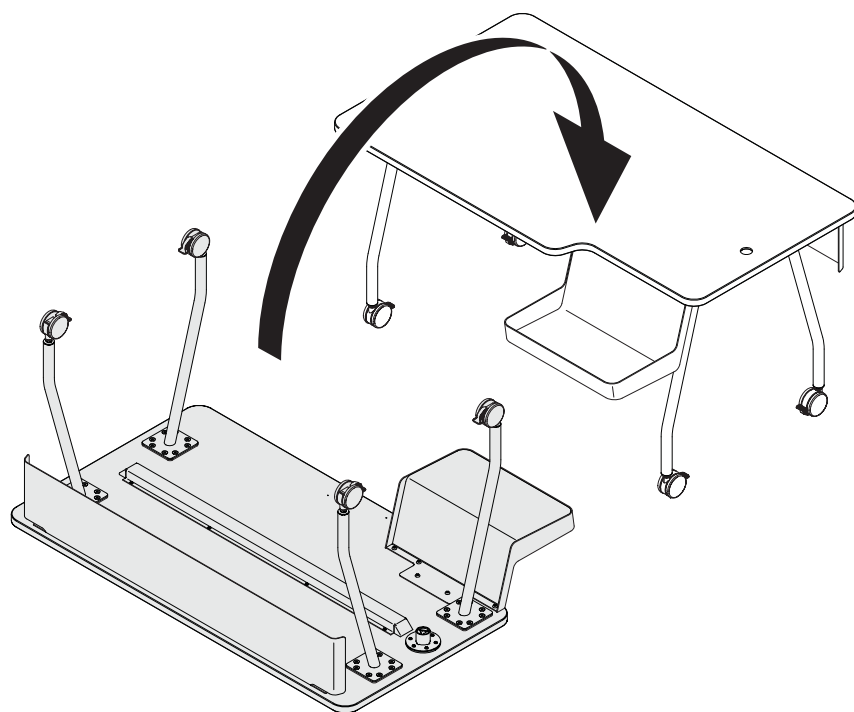

Note: Two people required.

8

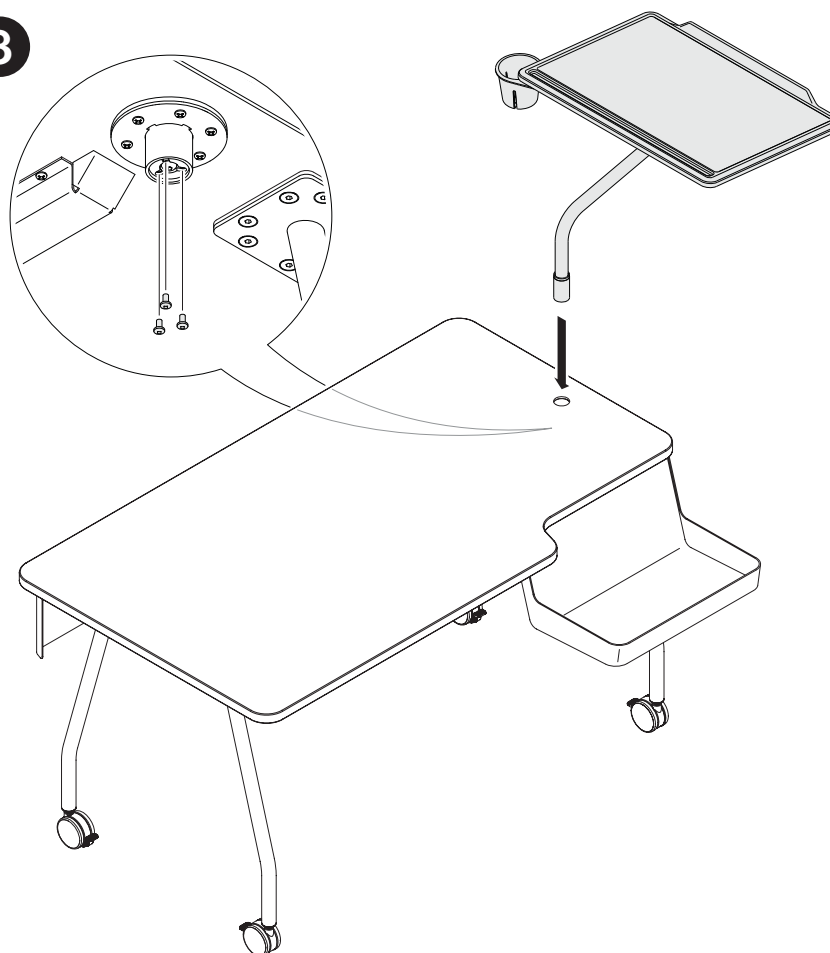

Three (3) Ø5 X 9mm wood screws