

- 1 - Flip-up
- 2 - Worksurface
- 3 - Plastic cover
- 4 - Share vertical beam
- 5 - Middle horizontal beam
- 6 - Side vertical beam
- 7 - Side leg (left and right)
- 8 - Side horizontal beam
- 9 - Cable tray
- 10 - Middle leg
- 11 - Add-on cable tray
(for 2-6 units Bench)

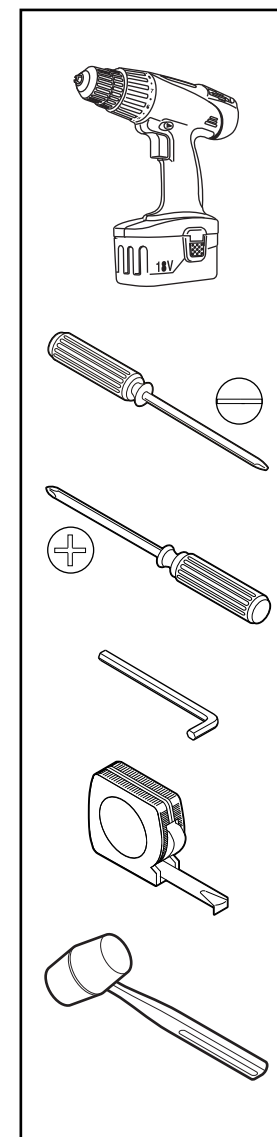

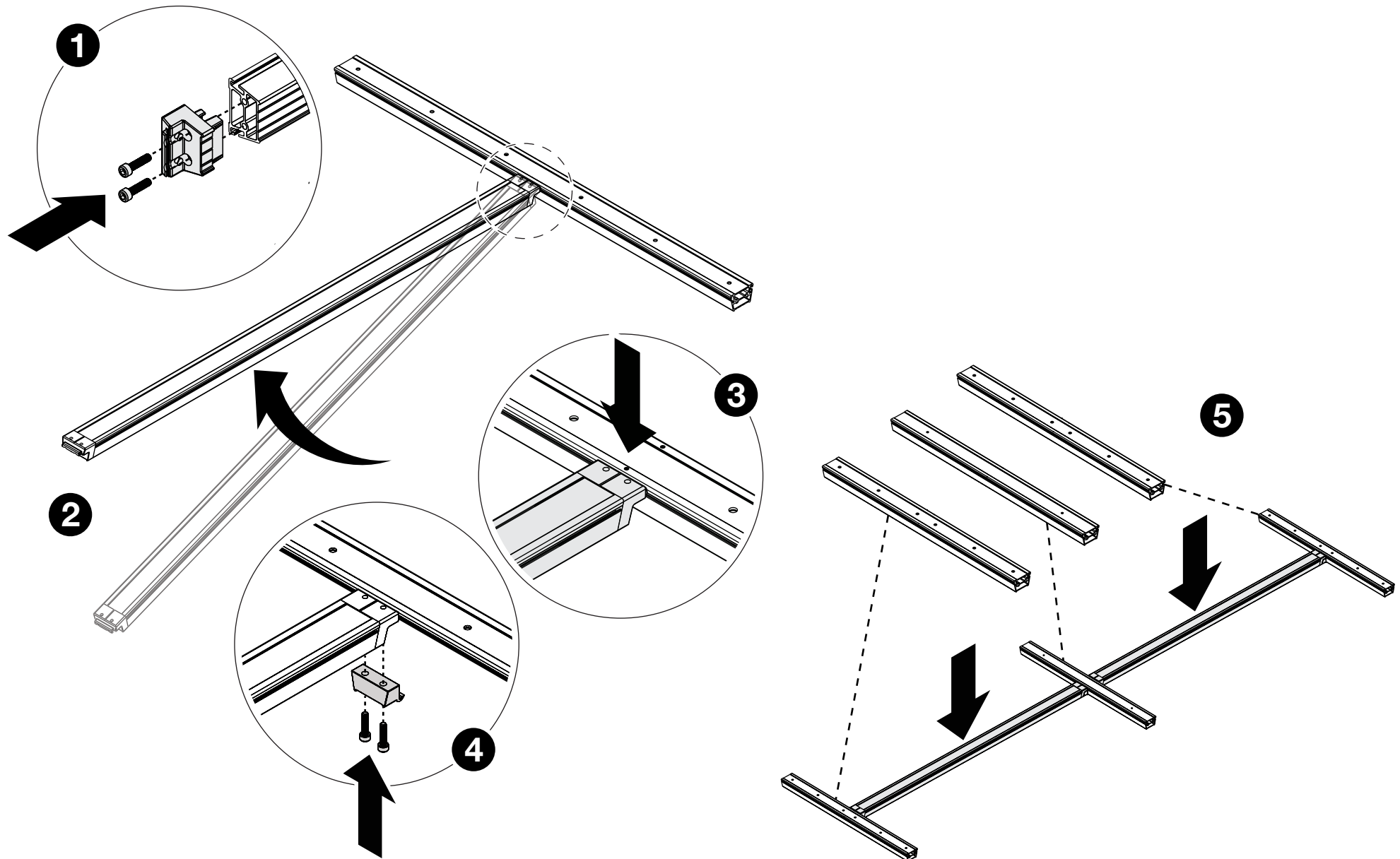

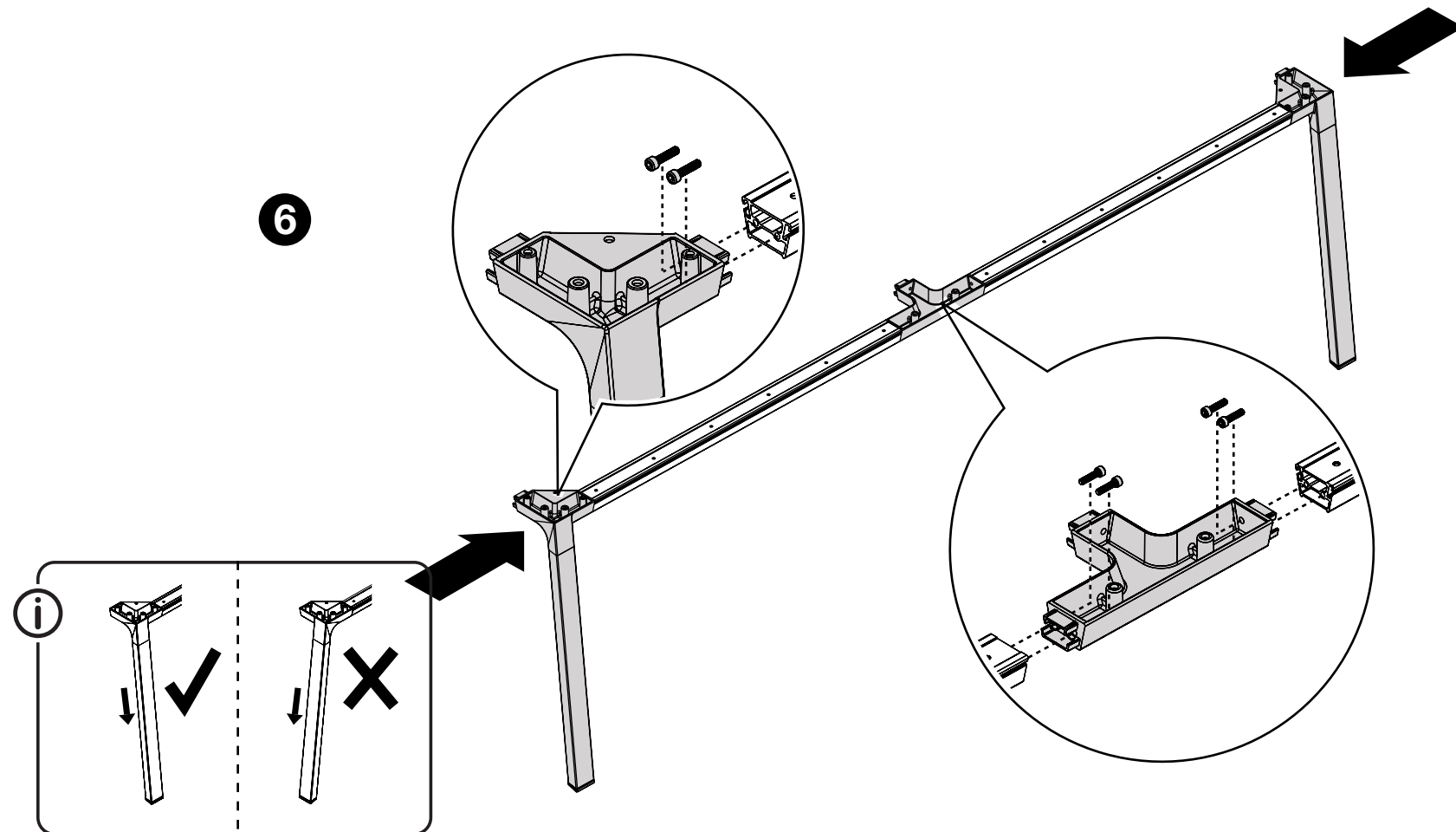

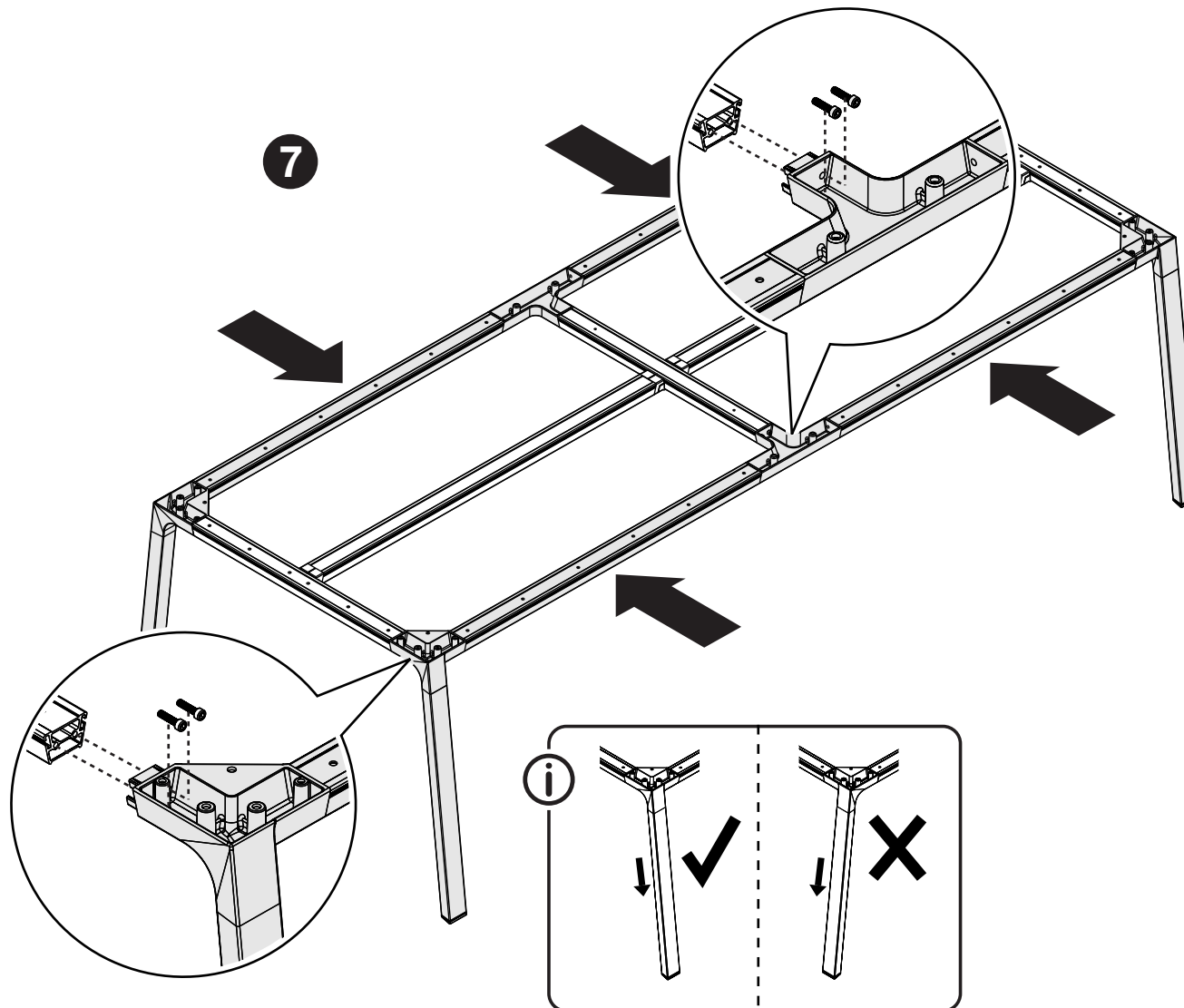

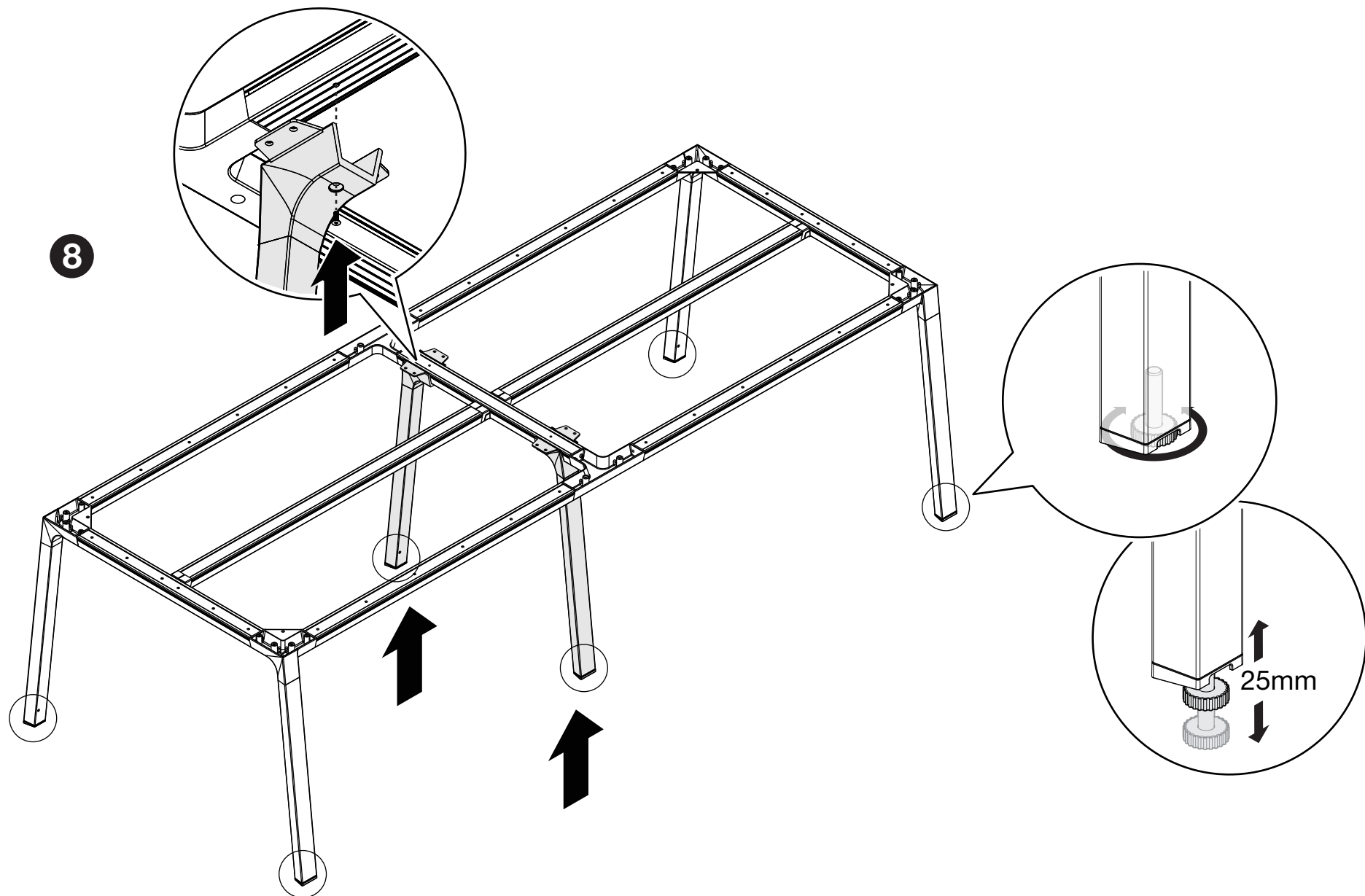

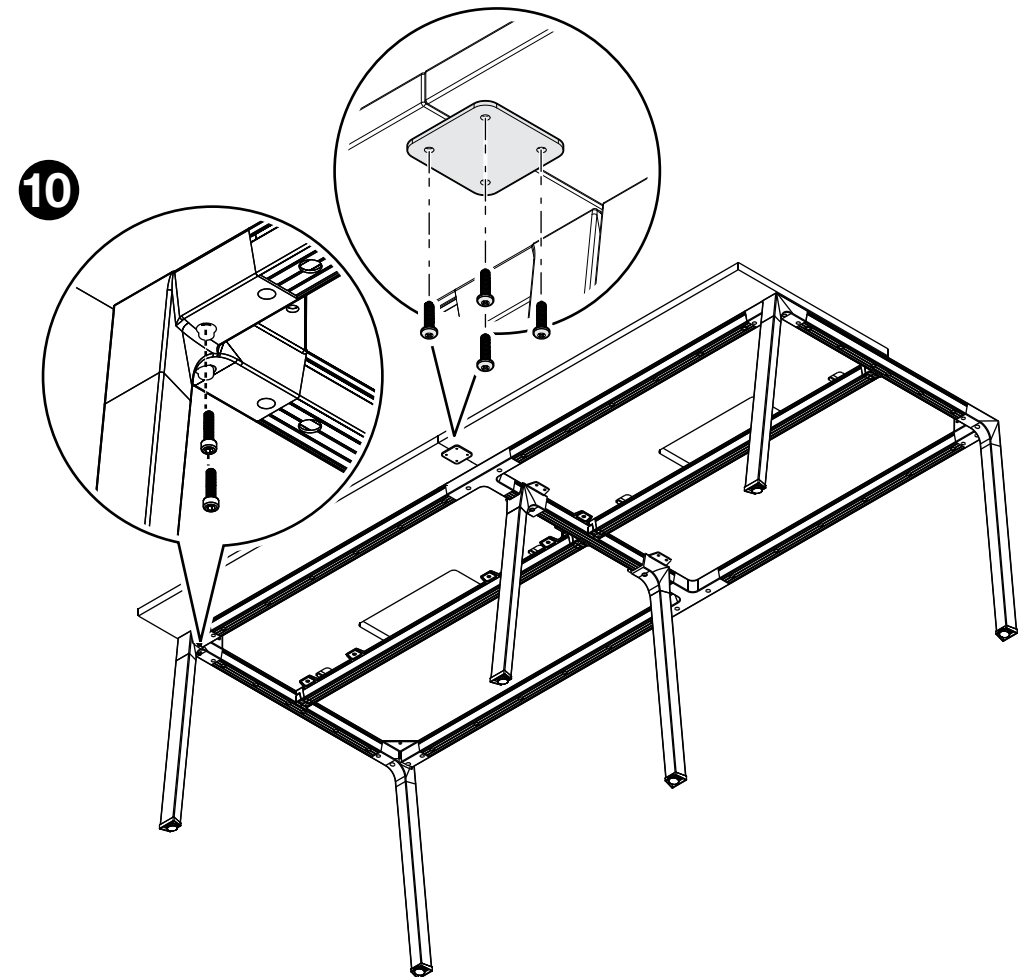
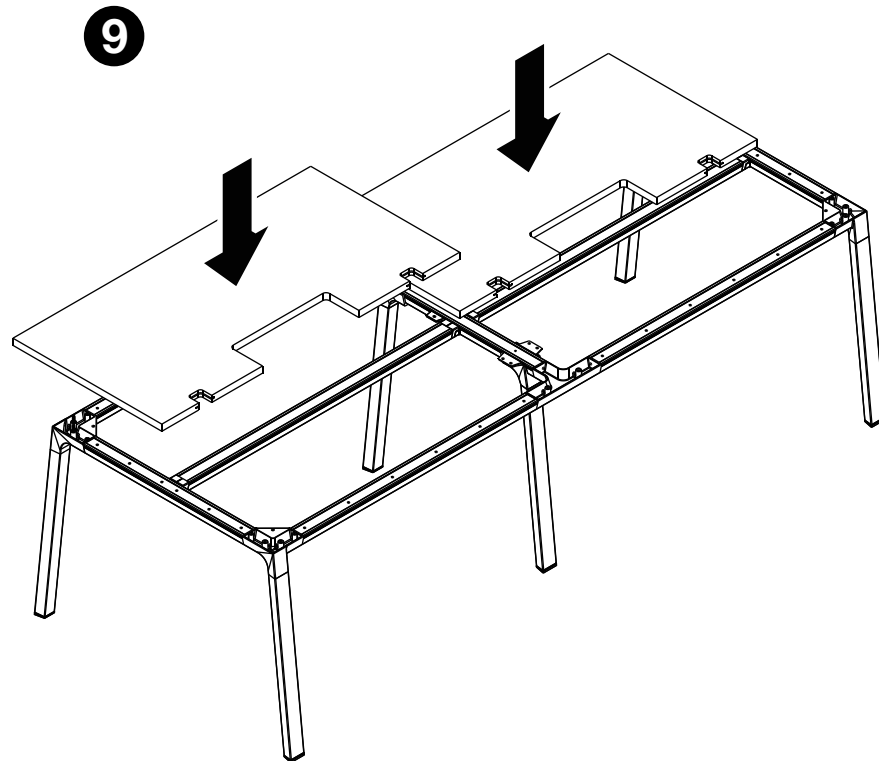

11

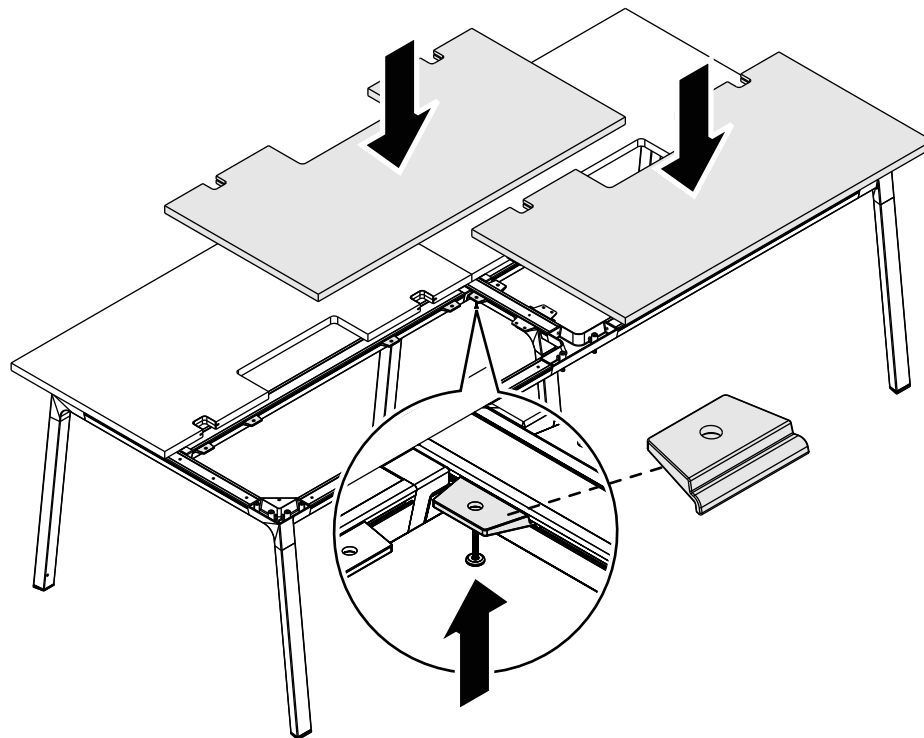

12

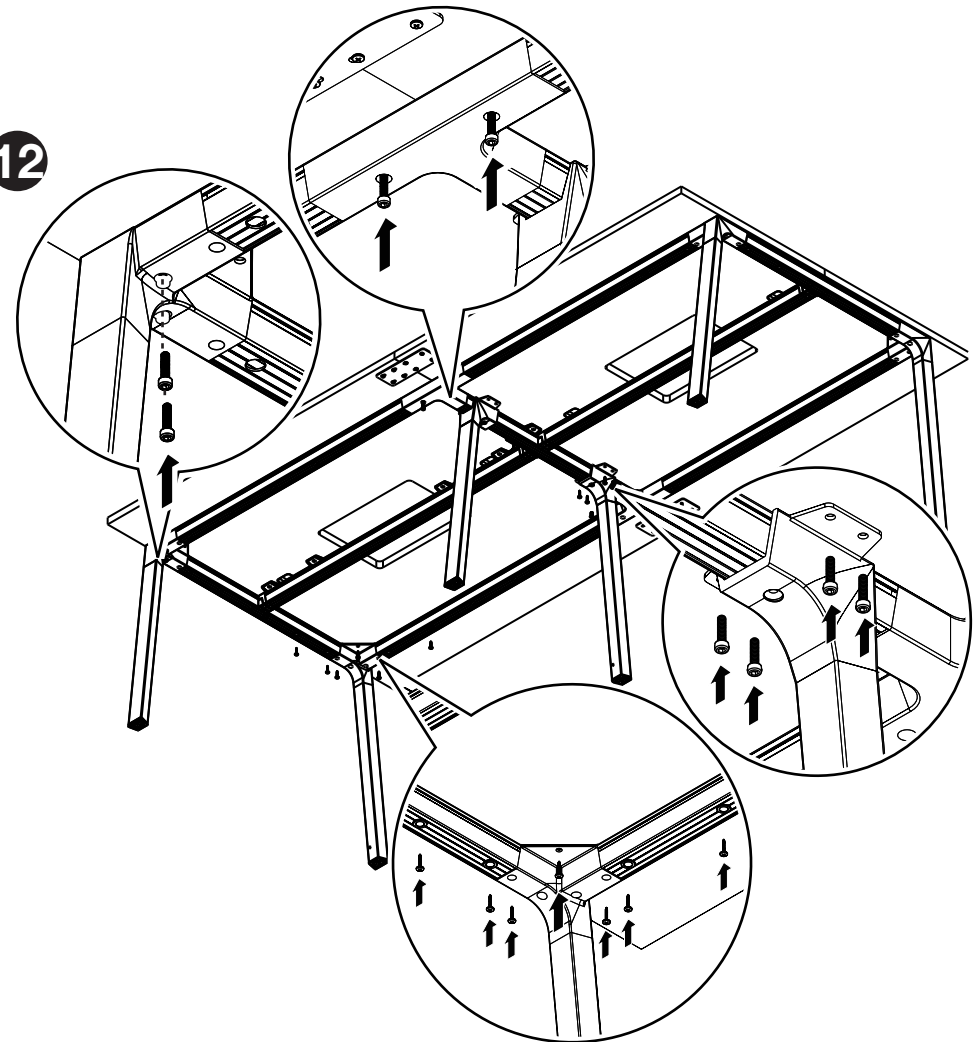

13

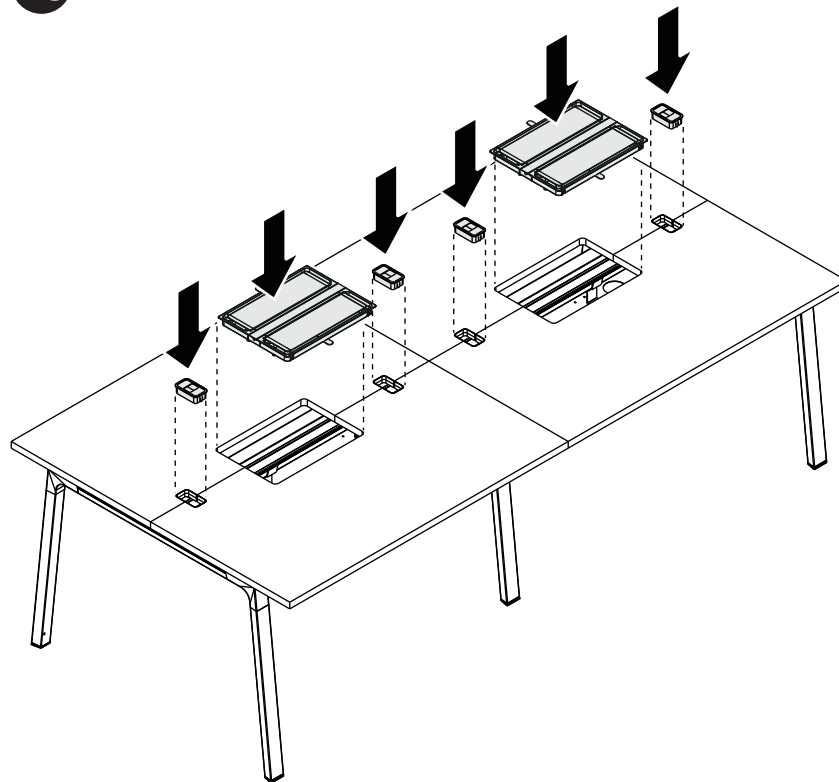

14

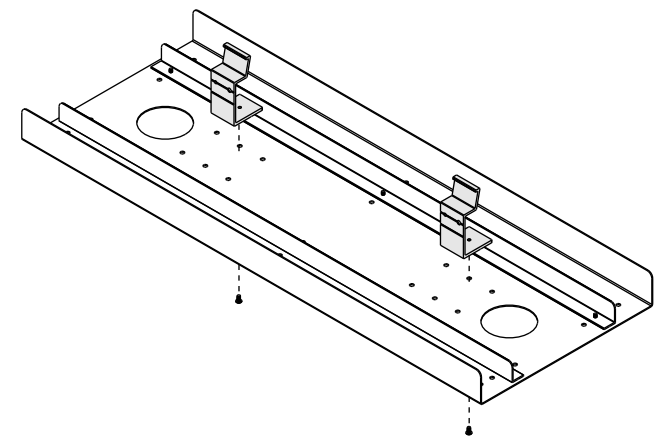

15

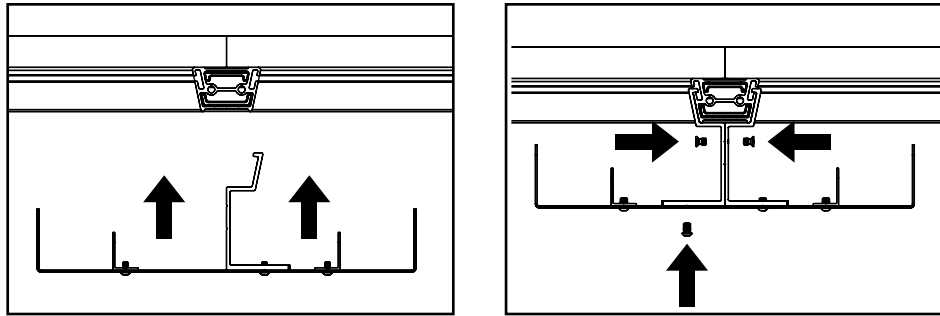

Cable Tray Position

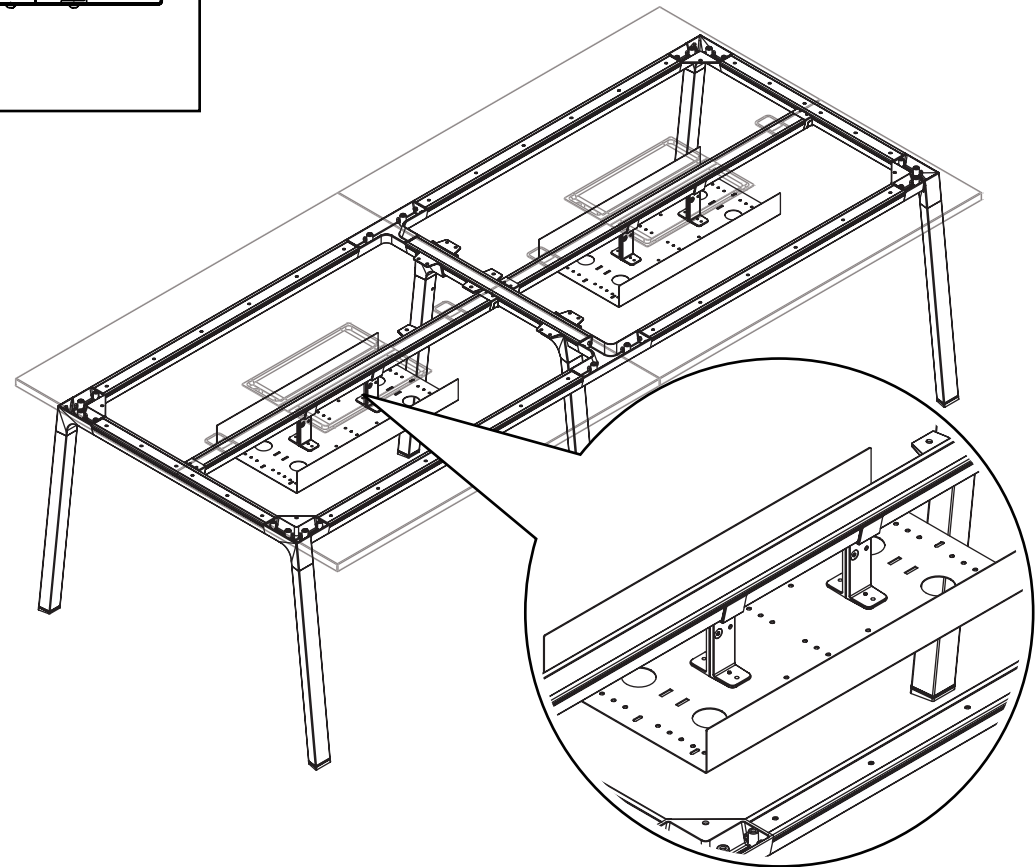
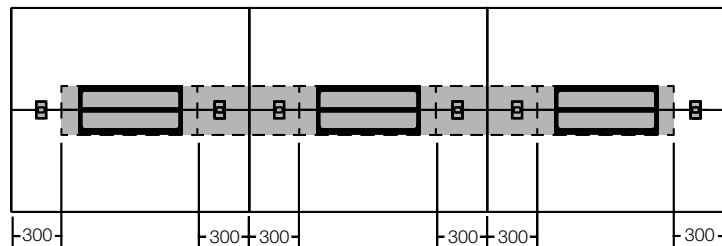
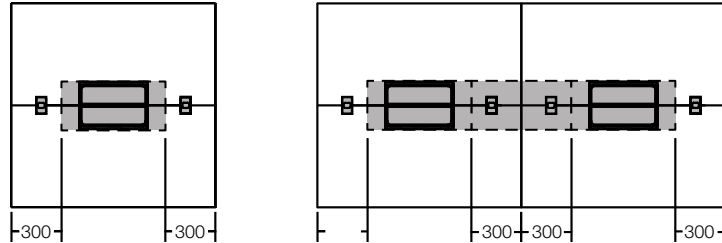

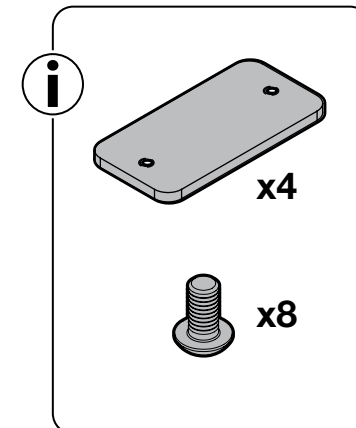
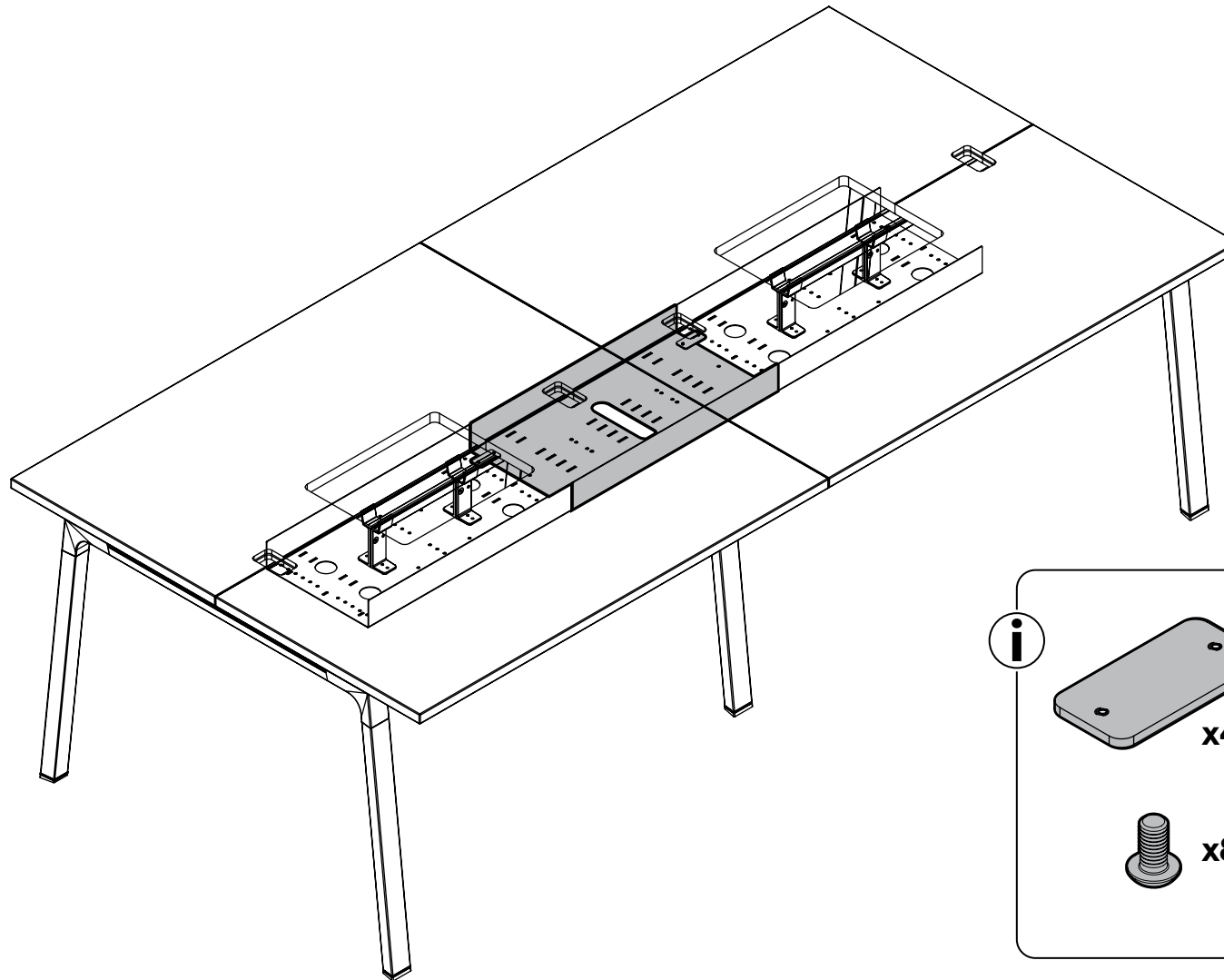

1

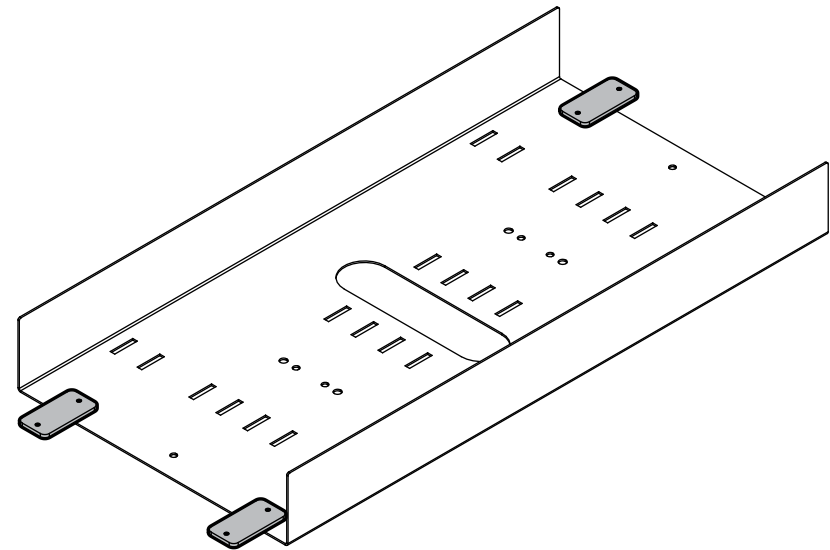
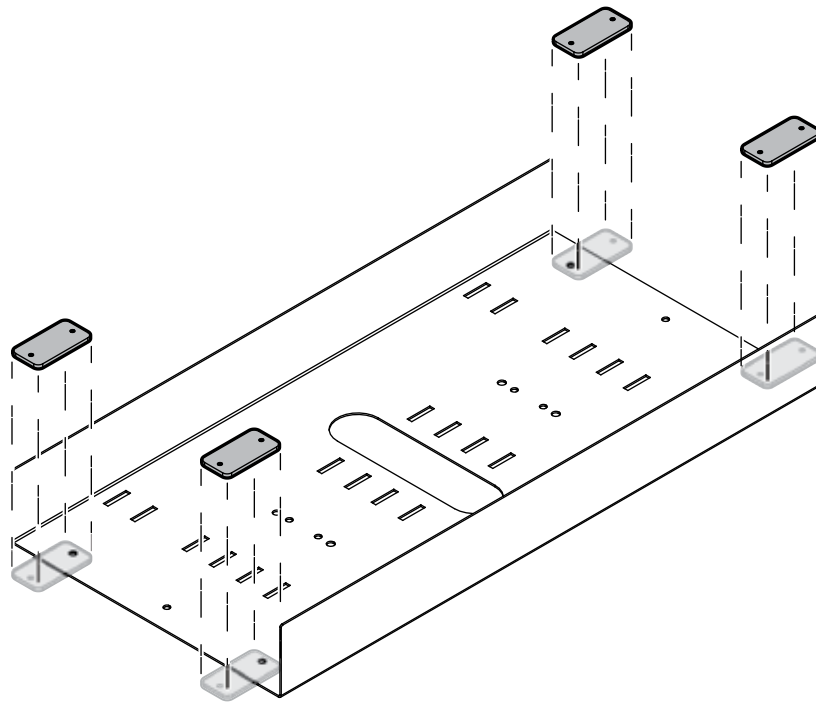

2

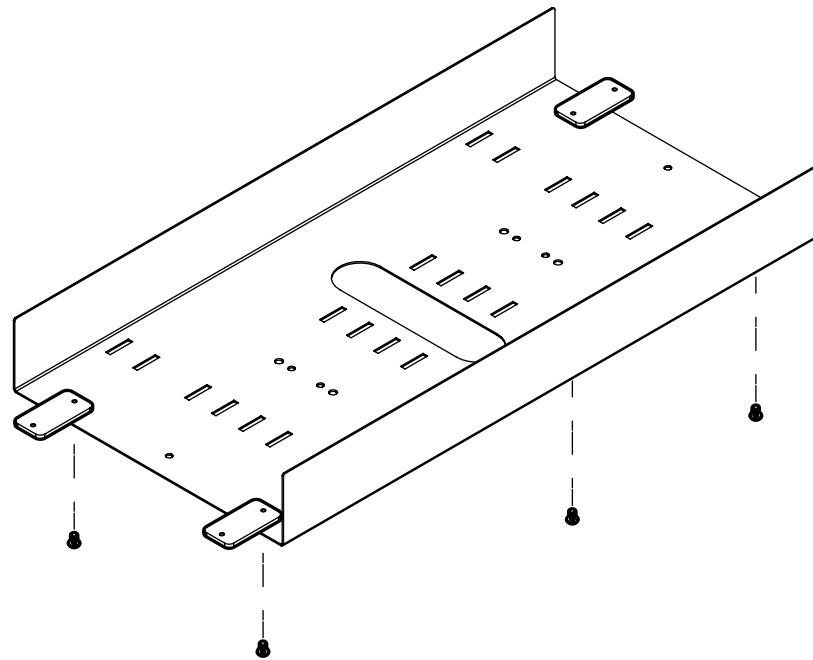

3

